

Planting Schedule

| TREES | | | | | | |
|-------|--------------------------|---|---------|-----------|---------|--------|
| CODE | SPECIES | SPECIFICATION | GIRTH | HEIGHT | DENSITY | NUMBER |
| BpT | Betula pendula 'Tristis' | Extra Heavy Standard: 3x: RB: Clear Stem min. 200cm | 16-18cm | 400-450cm | Counted | 3 No. |
| Pr av | Prunus avium | Extra Heavy Standard: 3x: RB: Clear Stem min. 200cm | 16-18cm | 400-450cm | Counted | 8 No. |
| Qr | Quercus robur | Extra Heavy Standard: 3x: RB: Clear Stem min. 200cm | 16-18cm | 400-450cm | Counted | 9 No. |
| Qu ro | Quercus robur | Semi-Mature: 3x: RB: Clear Stem min. 200cm | 20-25cm | 500-550cm | Counted | 30 No. |
| So au | Sorbus aucuparia | Extra Heavy Standard: 3x: RB: Clear Stem min. 200cm | 16-18cm | 400-450cm | Counted | 68 No. |

| SHRUBS | | | | | | |
|--------|-----------------------------------|------------------|----------|---------|------------------|----------|
| CODE | SPECIES | SPECIFICATION | POT SIZE | HEIGHT | DENSITY | NUMBER |
| LnM | Lonicera nitida 'Maigrün' | Bushy: 6 brks: C | 3L | - | 3/m ² | 3738 No. |
| PIOL | Prunus laurocerasus 'Otto Luyken' | Bushy: 3 brks: C | 3L | 30-40cm | 3/m ² | 287 No. |

| HEDGING | | | | | | |
|---------|-----------------|----------------------------------|----------|---------|---------|-----------|
| CODE | SPECIES | SPECIFICATION | POT SIZE | HEIGHT | DENSITY | NUMBER |
| Fs | Fagus sylvatica | 1+2: Transplant - seed raised: B | - | 60-80cm | 9/m | 10585 No. |

| WOODLAND STRUCTURE MIX 1 | | | | | | |
|--------------------------|--------------------|--|-------|----------|---------|---------|
| CODE | SPECIES | SPECIFICATION | GIRTH | HEIGHT | DENSITY | NUMBER |
| Agl | Alnus glutinosa | 1+1: Transplant - seed raised: B | - | 80-100cm | 1.5 Ctr | 292 No. |
| Bpe | Betula pendula | 1+1: Transplant - seed raised: B | - | 80-100cm | 1.5 Ctr | 874 No. |
| Cmo | Crataegus monogyna | 1+2: Transplant - seed raised: B | - | 80-100cm | 1.5 Ctr | 583 No. |
| Ptr | Populus tremula | 1+1: Transplant - seed raised: B | - | 80-100cm | 1.5 Ctr | 438 No. |
| Svim | Salix viminalis | 0/1: Cutting: Branched: 2 brks: B | - | 80-100cm | 1.5 Ctr | 292 No. |
| Ug | Ulmus glabra | 1+1: Transplant - seed raised: B | - | 80-100cm | 1.5 Ctr | 147 No. |
| Vo | Viburnum opulus | 1+2: Transplant - seed raised: Branched: 3 brks: B | - | 80-100cm | 1.5 Ctr | 292 No. |

| WOODLAND STRUCTURE MIX 2 | | | | | | |
|--------------------------|--------------------|----------------------------------|-------|----------|---------|----------|
| CODE | SPECIES | SPECIFICATION | GIRTH | HEIGHT | DENSITY | NUMBER |
| Bpe | Betula pendula | 1+1: Transplant - seed raised: B | - | 80-100cm | 1.5 Ctr | 2909 No. |
| Jc | Juniperus communis | Leader with Laterals: C | - | 30-40cm | 1.5 Ctr | 365 No. |
| Psyl | Prunus sylvestris | 1+2: Transplant - seed raised: B | - | 40-60cm | 1.5 Ctr | 2183 No. |
| Pav | Prunus avium | 1+1: Transplant - seed raised: B | - | 80-100cm | 1.5 Ctr | 728 No. |
| Qpe | Quercus petraea | 1+2: Transplant - seed raised: B | - | 80-100cm | 1.5 Ctr | 728 No. |
| Sau | Sorbus aucuparia | 1+1: Transplant - seed raised: B | - | 80-100cm | 1.5 Ctr | 365 No. |

| BULBS | | | | | | |
|-------|-------------------------|---------------|-------------------|----------|--|--|
| CODE | SPECIES | SPECIFICATION | DENSITY | NUMBER | | |
| NTT | Narcissus 'Tête-à-Tête' | Grade 10/12 | 25/m ² | 2792 No. | | |

Planting Notes

Trees, Ornamental Shrubs, Hedges and Grass

- All tree planting operations to be in accordance with BS 8545: 2014, TREES: 'From Nursery to Independence in the Landscape - recommendations'
- All planting material is to conform to BS 3936 - parts 1 to 5 Specification for Nursery stock.
- All landscape operations to be in accordance with BS 4428: 1989 Recommendations for general landscape operations.
- In line with recommendations from the Task Force on Tree Health and Plant Biosecurity all planting material is to be sourced from reputable nurseries in order to avoid spread of any pest and plant disease which may threaten the health of proposed or existing planting material. All necessary information with regards to the identity and source of the planting material, from original source, should be obtained from the nursery. For further details on notifiable, and non-notifiable, pests and diseases refer to the Department for Environment, Food & Rural Affairs (DEFRA) UK Plant Health Risk Register. Soil management and storage should follow best practice guides; refer to DEFRA, Construction Code of Practice for the Sustainable Use of Soils on Construction Sites.
- Any imported subsoil to be in accordance with BS 8601:2013 'Specification for subsoil and requirements for use', With debris and contamination removed, stone to be a maximum ring size of 100mm in any dimension.
- Any imported topsoil to be in accordance with BS 3882:2015 'Specification for topsoil', weed free, fertile medium loam with maximum 20% stone content. Stones to be a maximum ring size of 50mm in any dimension for general tree, shrub and hedge planting and 38mm maximum ring size for grass seed areas.
- Minimum topsoil depths shall be as follows:
 - 150 - 200mm for grass areas;
 - 300 - 450mm for shrub beds and hedges; and
 - Tree pits to have topsoil depths as indicated.
- Note:** Wildflower meadows generally require low soil fertility levels therefore it is recommended that any material imported to increase levels to marry in with surrounding areas be low fertility graded subsoils.
- All finished topsoil levels after top soiling operations to be 150mm higher than adjacent kerb tops in the centre of the planting, rolling over gently to 50mm below kerb top level, at edges, to allow for mulching, settling of soil and improved drainage. Where possible, allow several weeks to allow for any settling then add further soil to maintain original levels. Amenity grass to be flush to kerb.
- Extra heavy standard trees to be planted in pits 2000 x 2000 x 750mm depth. Tree pit to be backfilled with topsoil mixed with 25% Tree Planting Compost (TPC). Tree to be supported by 2 no. 1800mm long 300mm diameter softwood stakes, machine round pointed with a chamfered top, driven 1200mm depth with cross bar finished 600mm above ground. All posts and crossbars to be painted with two coats of dark black stain off site. Tree attached to centre of cross bar using Flat Back Unslotted Block and T260 Buckle Tree Tie by Rubberloc (or equal and approved). An urban watering system such as 'Mona Relief' watering system by Green-tech (or equal and approved) with inlet clearly visible is to be installed around root system to enable watering during the establishment period and during periods of extended dry weather or drought.
- Semi mature trees to be planted in pits 2000 x 2000 x 750mm depth. Tree pit to be backfilled with topsoil mixed with 25% Tree Planting Compost (TPC). Tree to be supported by underground guys using a proprietary system such as Platipus tree anchoring system by Green-tech (or equal and approved). An urban watering system such as 'Mona Relief' watering system by Green-tech (or equal and approved) with inlet clearly visible is to be installed around root system to enable watering during the establishment period and during periods of extended dry weather or drought.
- New conifer trees or bushy shrubs to be protected with 1500mm high Tubex Mesh Tree Guard by Green-tech (or equal and approved) fixed to timber stakes and secured with 3 no. plastic cable ties.
- Root barriers gt RootBarrier 325 by Green-tech (or equal and approved) to be installed vertically on either side of the planting trench to protect local underground services from tree roots where necessary, in accordance with manufacturer's instructions. Where installed tight against kerb, hunching is to be cut back as necessary to facilitate even installation. Ensure that barrier finishes at least 10mm above finished ground levels within planting beds which must be covered by the mulch layer.
- In clay soils or poor drainage situations base of all tree pits to have 60mm diameter upvc pipe backfilled with free draining 40/20 clean gravel wrapped in Terram 700 filter membrane and connected to stone filled soakaway.
- The base and side of tree pits ripped to 300mm depth at 300mm centres to prevent glazing and to demonstrate free drainage.
- Shrub planting areas and hedges to be cultivated to a depth of 450mm with sub-soil ripped to 150mm depth at 150mm centres. All stones over 50mm in any dimension are to be removed.
- Grass areas to be cultivated to a depth of 150mm with sub-soil shaped and trimmed to shed water graded to smooth even flowing contours to running levels prior to cross - ripped to 300mm depth at 300mm centres. All stones over 38mm in any dimension to be removed and the area to be brought to a fine tilt, uniformly firmed, a pre-seeding fertiliser applied and turfed or seeded with quality lawn turf or seed.
- All turf to be supplied and laid in accordance with BS 3969; 1998+A1; 2013 Recommendations for Turf for general purposes.
- Bulbs in grass shall be scattered within the planting area identified in random pattern and planted directly into the grass.
- Turf on slopes exceeding 1:4 shall be pegged into position using wooden or metal pegs to prevent slippage.
- Where grass runs up to vertical boundaries, such as walls and fences, grass is to be cut back by a minimum of 150mm to form a mowing margin. Mowing margin to be kept weed free.
- All containerised shrubs to be pit planted. Pits to be excavated 150mm deeper and wider than size of root ball. Pits to be backfilled with excavated material together with 50g of slow release fertiliser per plant for 3 litre pots and 10g for 25 litre pots. All plants to be carefully firmed in.
- All trees in grass to have a 1m diameter weed free circle formed and maintained around base.
- All planting shall be set out and planted as shown in the planting schedule and on the detailed planting plan drawings.
- All ornamental shrub beds, hedges and trees to be well watered in after planting.
- All shrub areas, hedges and trees in weed free circles to have a minimum depth of 50mm 20/0 well composted bark mulch fully regulated to BSI PAS 100 from an approved supplier, after all planting and prior to watering.

Woodland / Structure Planting

- All areas for structure planting shall be sprayed and weeds eradicated using a glyphosate based translocated herbicide prior to ground preparation and planting and kept weed free until woodland establishment.
- If after soil analysis nutrient levels are found to be deficient, an appropriate fertiliser will be incorporated into the soil prior to planting in accordance with manufacturer's instructions and in accordance with current guidelines.
- Cultivation should take place when the soil is friable, and this will depend on the rainfall pattern in the year before planting. Cultivation when the soil is very dry or wet will be difficult and may damage the soil. Autumn cultivation is generally advisable. Cultivation in the winter, i.e. just before planting, is unlikely to be effective and may do more harm than good to the soil.
- Where ground has been previously cultivated all bare root whips, transplants and cell grown stock to be notch planted into weed free ground.
- Where ground requires regarding or mounding any sub-soil to be ripped to 300mm depth at 300mm centres to relieve compaction and improve drainage.
- Surface stone and debris above 100mm size to be removed prior to topsoil being spread.
- Site agent to inspect subsoil prior to topsoil spreading.
- Approved topsoil spread to a depth of 300 - 450mm to design levels with all stone and debris over 100mm in any dimension to be removed.
- Post and wire fencing shall be erected to provide protection and designate structure planting areas. Where there is animal grazing on land adjacent, a suitable stock-proof fence or plastic spiral guards secured with a bamboo cane is to be erected to protect proposed tree/ shrub saplings. If there is evidence of rabbits and/ or deer in the area, fencing is to be made rabbit and/ or deer-proof.

Suppliers (as specified or equal and approved).
 Tree accessories: Green-tech Tel: 01423 332100
 Tree ties and moulded rubber spacer: Rubberloc Tel: 01902 440253

GRASS SEED MIXES

Woodland meadow mix

- Bluebell Seed (Hyacinth non Scripta) 0.5%
- Common Agrimony (Agrimonia Eupotar) 1.0%
- Hedge Bedstraw (Galium Mollugo) 3.0%
- Hedge Garlic (Alliaria Petiolata) 2.0%
- Hedge Woundwort (Stachys Sylvatica) 0.5%
- Herb Bennet (Geum Urbanum) 1.0%
- Nettle Leaved Bell Flower (Campanula Trachnium) 0.2%
- Ragged Robin (Lychnis Flos Cuculi) 0.2%
- Red Campion (Silene Dioca) 3.4%
- Self Heal (Prunella Vulgaris) 3.4%
- Square St Johns Wort (Hypericum tetrapterum) 0.1%
- Sweet Cicely (Myrrhis Odorta) 0.6%
- Upright Hedge Parsley (Torilis Japonica) 2.0%
- Welsh Poppy (Meconopsis Cambria) 0.05%
- Wild angelica (Angelica Sylvestri) 0.05%
- Wild Foxglove (Digitalis Purpurea) 1.5%
- Wood sage (Teucrium Scorodonia) 0.18%
- Browntop Bent 5% Crested Dogstail 5%
- Sheeps Fescue 23%, Chewings Fescue 25%
- Slender Creeping Red Fescue 20%
- Yellow Oat Grass 1.0%
- Sweet Vernal Grass 1.0%

Sowing rate: 2.00 g/m²

Amenity grass mixture

A19 is a tough multipurpose mixture suitable for domestic lawns and commercial landscape projects. No real ecological value but included for completeness.

- Corall slender creeping red fescue 30%
- Calliipe chewings fescue 25%
- Abernile perennial ryegrass 20%
- Vesuvius perennial ryegrass 20%
- Highland browntop bent 5%

Sowing rate: 50.00 g/m²

Grassland meadow mixture

- Festuc rubra ssp litoralis Slender Creeping Red Fescue 24%
- Festuca longifolia Hard Fescue 20%
- Festuca ovina Sheeps Fescue 20%
- Cynosurus cristatus Crested Dogstail 10%
- Pheleum bertolonii Small Leaved Timothy 5%
- Agrostemma githago Corn Cockle 4.2%
- Leucanthemum vulgare Oxeye Daisy 2%
- Centaura cyanus Cornflower 1.6%
- Papaver rhoeas Corn Poppy 1.6%
- Anthemis arvensis Corn Chamomile 1.5%
- Chrysanthemum segetum Corn Marigold 1.5%
- Centaura nigra Common Knapweed 1.4%
- Plantago lanceolata Ribwort Plantain 1.4%
- Prunella vulgaris Self Heal 1.2%
- Anthoxanthum odoratum Sweet Vernal 1%
- Ranunculus acris Meadow Buttercup 1%
- Sanguisorba minor Salad Burnet 1%
- Digitalis purpurea Foxglove 0.4%
- Silene alba White Campion 0.4%
- Silene diocia Red Campion 0.4%
- Lotus corniculatus Birdsfoot Trefoil 0.2%
- Melilotus alba White Melilot 0.2%

Sowing rate: 5.00 g/

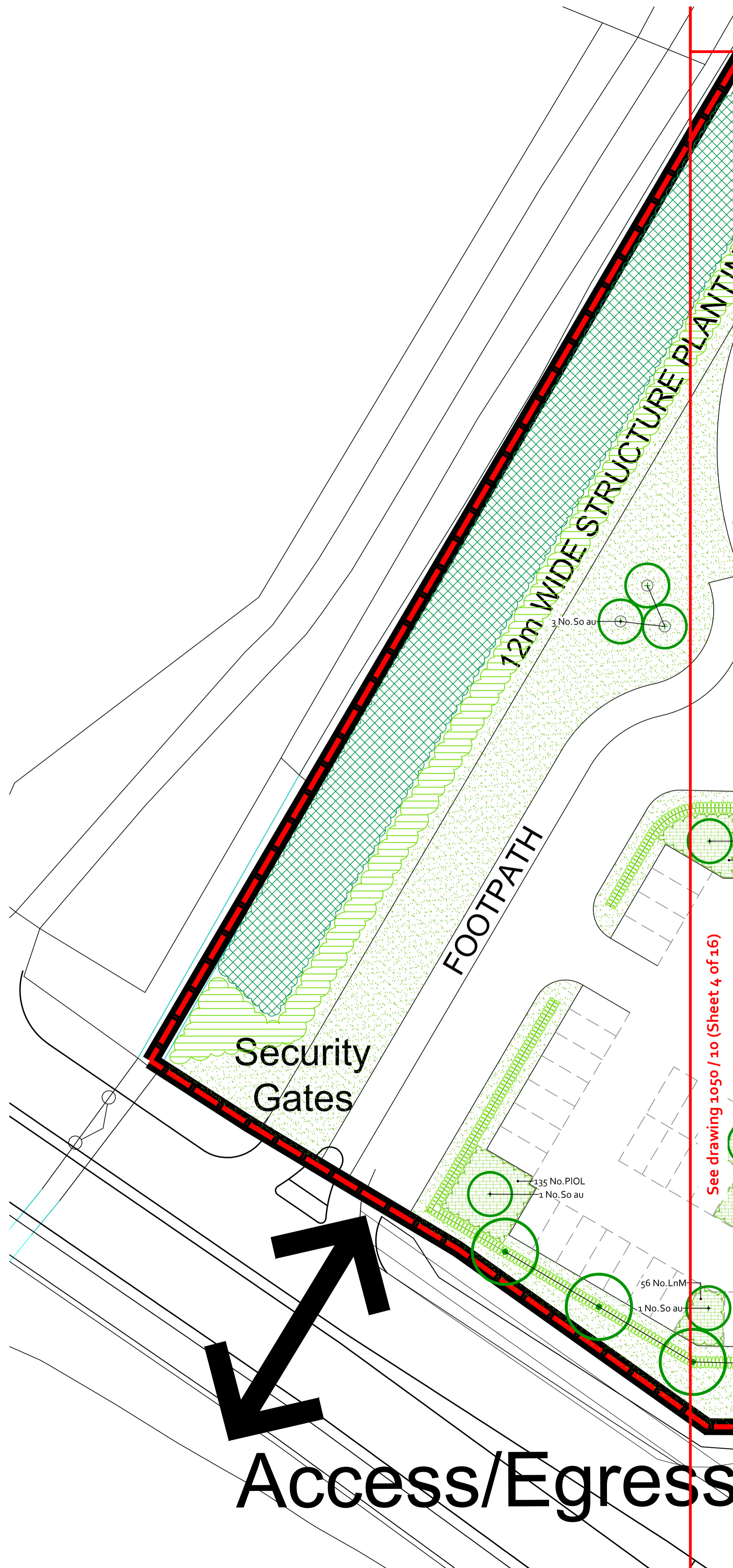

Legend

- Existing vegetation to be retained and protected
- Proposed semi mature tree planting (see planting schedule)
- Proposed tree planting in 1m diameter weed free circles (see planting schedule)
- Proposed tree planting in hedge (see planting schedule)
- Proposed tree planting in shrubs (see planting schedule)
- Proposed hedge planting (see planting schedule)
- Proposed ornamental shrub planting (see planting schedule)
- Proposed close mown Amenity grass mix (see planting schedule)
- Proposed structure woodland planting 1 with Woodland meadow grass mix (see planting schedule)
- Site boundary

General Notes

- Prior to commencement of any work on site, protective fencing must be erected around existing trees to be retained in accordance with BS 5837:2012.
- Prior to any deep cultivation or excavation of planting pits the landscape contractor must check with the site manager / engineer for exact locations of any underground services.
- Proposed structural woodland planting to be protected with temporary fencing and spiral guards to ensure successful establishment.
- Some tree positions may have to be amended to accommodate any amendments to locations of services.
- Sports pitch treatment by others.
- For information on surface materials & details of hard landscape features such as walls & fences refer to architect's drawings.
- For information on levels & drainage refer to engineer's drawings.
- Limited information with regard to levels, drainage & underground services was available to us at time of preparation of drawing.
- For Maintenance and Management Proposals refer to separate A4 document.

Rev A: 09/01/2017 - Drawing updated to accommodate revised site layout. Planting Schedule updated. (GB)

| | |
|--|---|
| Project: Kingsford, Aberdeen | Client: Thomson Management Consultants |
| Drawing Title: Planting Plan (Sheet 2 of 16) | |
| Scale: 1:250 @ A1 | Date: 25 / 11 / 2016 |
| Drawing No: 1050 / 08 Rev A | Status: Planning |
| Drawn by: S Cochran-Sharp | Checked by: R Wilkie |
| | |
| a: Axwell House, East Mains Industrial Estate, Broxburn, West Lothian EH52 5AU t: 01506 858 757 w: brindleyassociates.co.uk © Brindley Associates Ltd. | |

